

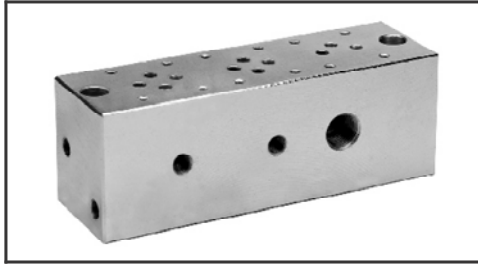

疊加式油路塊

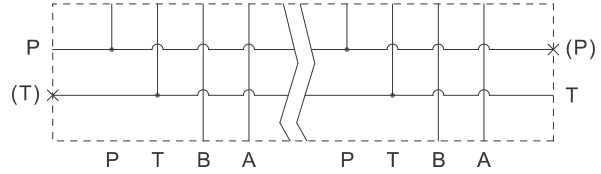

液壓符號



訂貨型號說明

MB	02	-5E	-1
型號	公稱通徑	閥聯數	接口螺絲形式
疊加式多聯油路板	02: 6mm 03: 10mm	1E: 1聯 4E: 4聯 2E: 2聯 5E: 5聯 3E: 3聯	1: PT螺絲 2: NPT螺絲

安裝尺寸

● MB02-1E-※

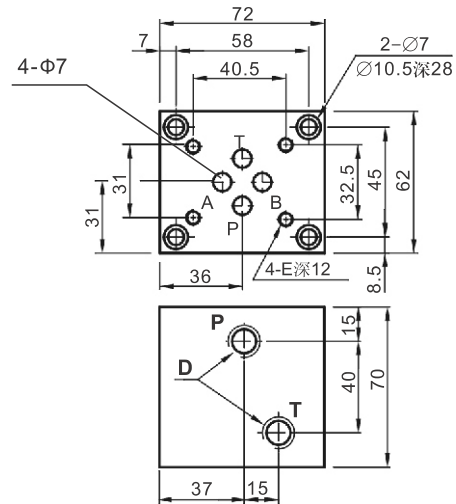
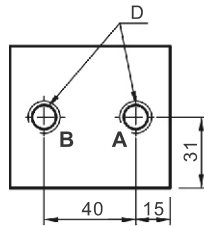

型號	MB02-1E-1	MB02-1E-2
D	PT 3/8"	NPT3/8"
E	M5X0.8P	#10-24 UNC

● MB03-1E-※

型號	MB03-1E-1	MB03-1E-2
C	PT 3/4"	NPT3/4"
D	PT 1/2"	NPT1/2"
E	M6X1.0P	1/4-20 UNC

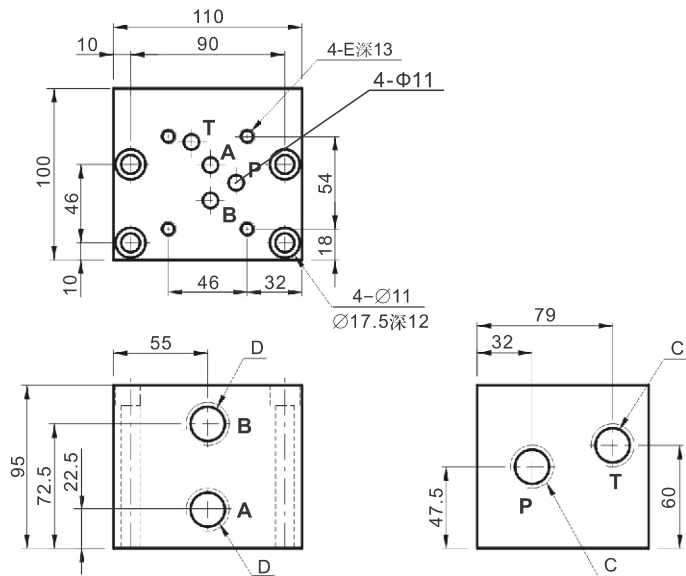
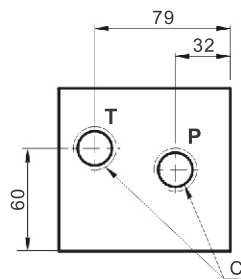

A
B
C
D
E
F
G
H
I
J
K

疊
加
閥



● MB02-※E-※

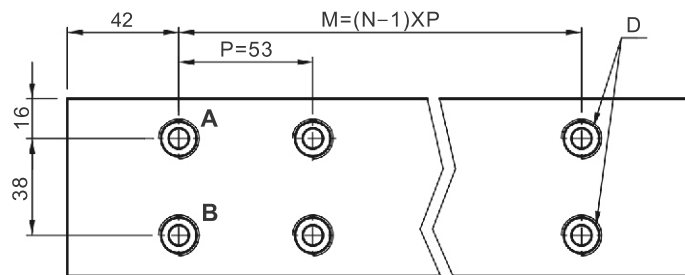
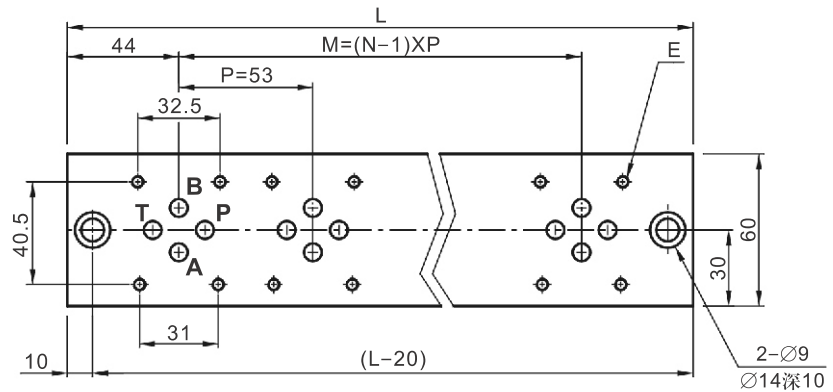
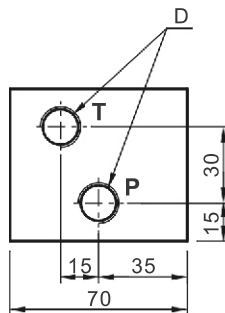
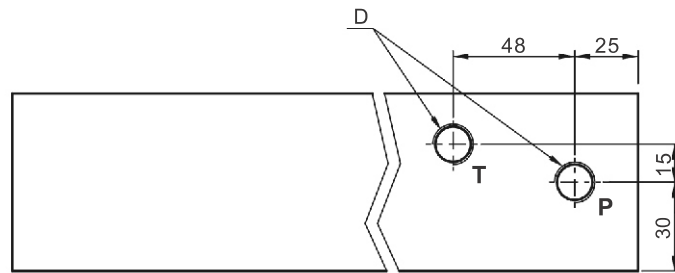

型號		D	E	N	M	L	重量(Kg)
MB02-2E	1	PT 3/8"	M5×0.8P	2	53	141	4.6
	2	NPT 3/8"	#10-24UNC				
MB02-3E	1	PT 3/8"	M5×0.8P	3	106	194	6.3
	2	NPT 3/8"	#10-24UNC				
MB02-4E	1	PT 3/8"	M5×0.8P	4	159	247	8.1
	2	NPT 3/8"	#10-24UNC				
MB02-5E	1	PT 3/8"	M5×0.8P	5	212	300	10.0
	2	NPT 3/8"	#10-24UNC				
MB02-6E	1	PT 3/8"	M5×0.8P	6	265	353	11.8
	2	NPT 3/8"	#10-24UNC				
MB02-7E	1	PT 3/8"	M5×0.8P	7	318	406	13.6
	2	NPT 3/8"	#10-24UNC				

D

疊加閥



● MB03-※E-※

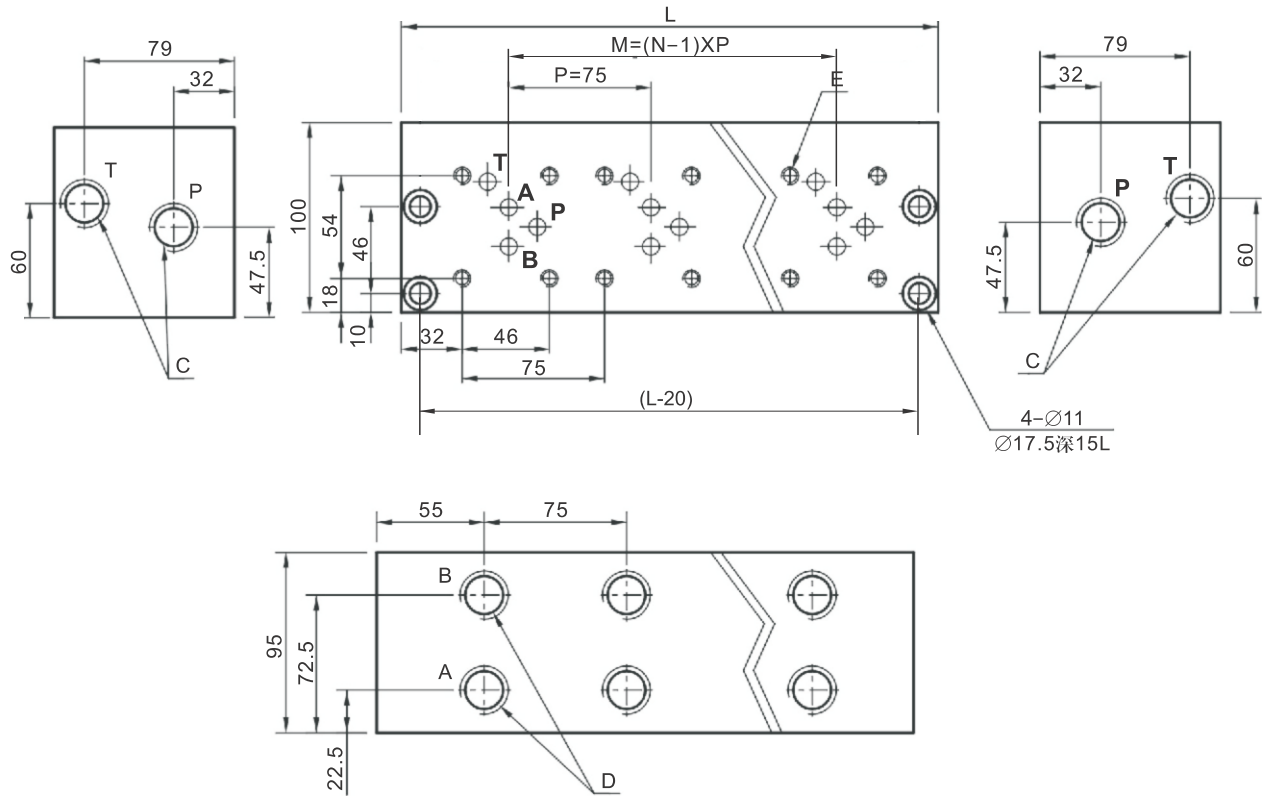

型號		C	D	E	N	M	L	重量(Kg)
MB03-2E	1	PT 3/4"	PT 1/2"	M6×1P	2	75	185	13.8
	2	NPT 3/4"	NPT 1/2"	1/4-20UNC				
MB03-3E	1	PT 3/4"	PT 1/2"	M6×1P	3	150	260	19.5
	2	NPT 3/4"	NPT 1/2"	1/4-20UNC				
MB03-4E	1	PT 3/4"	PT 1/2"	M6×1P	4	225	335	25.0
	2	NPT 3/4"	NPT 1/2"	1/4-20UNC				
MB03-5E	1	PT 3/4"	PT 1/2"	M6×1P	5	300	410	31.0
	2	NPT 3/4"	NPT 1/2"	1/4-20UNC				

A
B
C
D
E
F
G
H
I
J
K

疊
加
閥